

## Product Information

### Materials testing machine Z1200E with testControl II

CTA: 96025 78874



Z1200E with hydraulic grips

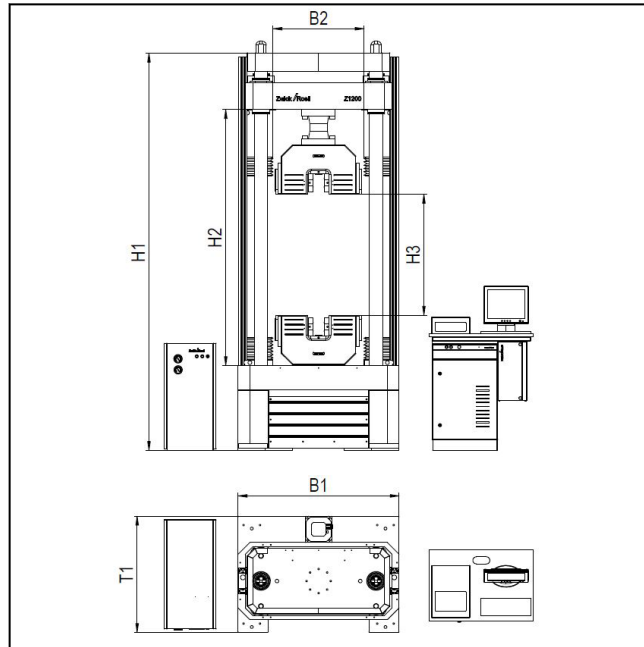

Drawing: Z1200E with hydraulic grips

#### Advantages and features

##### Modern load-frame design

- The robust load-frame features four hard-chromed guide-columns and massive base and moving cross-heads, ensuring excellent guidance properties and a high level of machine stiffness.
- Maintenance-free digitally controlled AC drive technology combined with an innovative motor feedback system allows excellent constant speed characteristics to be achieved even at extremely low speeds.
- The backlash-free pre-stressed precision ball-screws with digitally controlled AC servo drive allow virtually maintenance-free operation.
- The large test area combined with low overall height enables specimens and components with a wide range of lengths to be tested.
- The testing machine is positioned directly on the ground with no foundation.

##### Operator convenience

- Convenient operating height for specimen insertion with grips installed.
- testXpert III's intelligent test environment concept reduces set-up times and increases productivity.

#### Innovative electronics

- The new testControl II measurement and control electronics provide the ideal basis for precise, reproducible test results.
- Developed in-house by ZwickRoell, the electronics impress through maximum accuracy, high measured-value rates and flexible modularity.

#### Satisfying the most demanding safety requirements

- Compliance with the statutory safety requirements of the EC Machinery Directive is ensured in all materials testing machines, while an EC Declaration of Conformity accompanies every machine supplied.
- Only the latest safety technology and proven industrial components are used.
- The highest degree of safety for the operator, test results, specimen material, and testing system are guaranteed.

#### Future-proof

- Modular design means that the testing system can be re-equipped or upgraded whenever required.
- Moreover, testControl II control electronics are compatible with future-generation ZwickRoell software.
- Even after a product has been discontinued, spare parts remain available for a minimum of 10 years.

## Product Information

### Materials testing machine Z1200E with testControl II

Description	Value	
<b>Load frame</b>		
Paint finish	RAL 7011 iron gray and RAL7038 agate gray	
Ambient temperature	+10 ... +35	°C
Humidity (non-condensing)	20 ... 90	%
<b>Drive</b>		
Motor	AC servo motor with concentrated windings, Hiperface® motor feedback system	
motor holding brake	yes	
Control, set-value specification	digital (real-time Ethernet, EtherCAT®)	
Controller/cycle time	adaptive / 1000	Hz
Repeat positioning accuracy on crosshead	± 1.0	µm
<b>Measurement and control electronics</b>		
Number of slots available for measurement and control module	5 synchronized module bus slots, 1 synchronized PCIe slot <sup>1)</sup>	
Force measurement	Class 0.5 from 1% of Fmax / Class 1 from 0.2 % of Fmax, as per EN ISO 7500-1, ASTM E4, JIS B 7721	
Calculated resolution (e.g. load cell in tensile/compression direction)	24	bit
Measured-value sampling-rate, internal	400	kHz
Measured-value transmission rate to PC	500 (optionally 2000)	Hz
Zero-point correction	automatic, at start of measurement	
Measurement signal runtime correction for all channels	yes	
Interface to PC	Ethernet	
Eco mode?	yes, power unit automatically switched off (time adjustable)	
CE compliance?	yes, as per Machinery Directive 2006/42EC	
<b>Electrical supply data</b>		
Mains supply frequency	50/60	Hz
Electrical supply	400 +/- 10 %	V, 3Ph/PE
Power consumption	24.5	kVA

1) A high-quality DCSC measurement module for one load cell is included in delivery (occupies one module bus slot).

#### Options<sup>1)</sup>

Description
Display-equipped remote control for testControl II
Measured-value transmission-rate increase from standard 500 Hz to 2000Hz
Add-on table unit for electronics cabinet, with CPU-holder
ZwickRoell extensometer attachment (see catalog)
Front/rear safety device
Lead-screw guard
Side test-area

1) See catalog for item numbers and further details

## Product Information

### Materials testing machine Z1200E with testControl II

#### Product data

Type	Standard	H1-500	H1+500	H1+1000	B1+400	
Item Number	1015376	1021338	1021335	1021339	1021340	
<b>Load frame</b>						
Test force $F_N$ in tens./comp. direction	1200	1200	1200	1200	1200	kN
No. of guide columns	4	4	4	4	4	
No. of drive screws	2	2	2	2	2	
Stiffness of load frame at H2 = 1000 mm	1972	1972	1972	1972	1034	kN/mm
Height - H1	3635	3135	4135	4635	3635	mm
Width - B1	1470	1470	1470	1470	1870	mm
Depth - T1	1063	1063	1063	1063	1063	mm
Test-area width - B2	830	830	830	830	1230	mm
Test-area height - H2	2340	1840	2840	3340	2340	mm
Test stroke - H3 (with hydraulic grips)	1080	580	1580	2080	1080	mm
Weight without attachments	6700	6200	7000	7200	7600	kg
with hydraulic grips	8200	7600	8400	8600	9000	kg
Specific floor loading (with hydraulic grips)	2.5	2.3	2.5	2.4	2.7	kg/cm <sup>2</sup>
Noise level at maximum test-speed	<68	<68	<68	<68	<68	dBA
<b>Drive</b>						
Crosshead speed	0.00005 to 400	0.00005 to 400	0.00005 to 400	0.00005 to 400	0.00005 to 400	mm/min
Increased crosshead return speed (at reduced force)	550	550	550	550	550	mm/min
Displacement resolution of drive	0.000254	0.000254	0.000254	0.000254	0.000254	μm

#### Overview of load frame

CTA: 77812

